

Gewindeflansche / Screwed Flanges

EN 1092-1 Typ 13



Werkstoff / Material:
1.4541 / 1.4571

Maße in mm

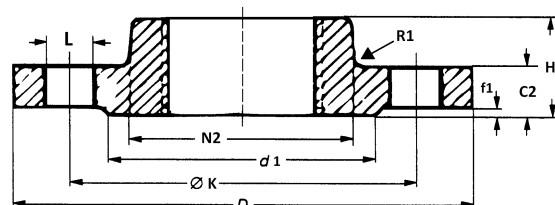

| Rohr-Anschluss/Tube | | PN | Flansch / Flange | | | | Ansatz / Hub | | Dichtleiste Raised face | | Schrauben / Drilling | | | Gewicht/ Weight in kg |
|---------------------|---------|-------------|------------------|----------------|-----|----------------|----------------|----------------|-------------------------|----------------|---------------------------|--------|----|-----------------------|
| DN | Gewinde | | D | C ₂ | K | H ₁ | N ₂ | R ₁ | d ₁ | f ₁ | Anzahl / Gewinde / Number | Thread | L | |
| 10 | 3/8" | 10/16/25/40 | 90 | 16 | 60 | 22 | 30 | 4 | 40 | 2 | 4 | M12 | 14 | 0,60 |
| 15 | 1/2" | 10/16/25/40 | 95 | 16 | 65 | 22 | 35 | 4 | 45 | 2 | 4 | M12 | 14 | 0,70 |
| 20 | 3/4" | 10/16/25/40 | 105 | 18 | 75 | 26 | 45 | 4 | 58 | 2 | 4 | M12 | 14 | 1,00 |
| 25 | 1" | 10/16/25/40 | 115 | 18 | 85 | 28 | 52 | 4 | 68 | 2 | 4 | M12 | 14 | 1,25 |
| 32 | 1 1/4" | 10/16/25/40 | 140 | 18 | 100 | 30 | 60 | 6 | 78 | 2 | 4 | M16 | 18 | 1,90 |
| 40 | 1 1/2" | 10/16/25/40 | 150 | 18 | 110 | 32 | 70 | 6 | 88 | 2 | 4 | M16 | 18 | 2,05 |
| 50 | 2" | 10/16 | 165 | 18 | 125 | 28 | 84 | 5 | 102 | 2 | 4 | M16 | 18 | 3,00 |
| 65 | 2 1/2" | 10/16 | 185 | 18 | 145 | 32 | 104 | 6 | 122 | 2 | 8b | M16 | 18 | 3,00 |
| 80 | 3" | 10/16 | 200 | 20 | 160 | 34 | 118 | 6 | 138 | 2 | 8 | M16 | 18 | 4,00 |
| 100 | 4" | 10/16 | 220 | 20 | 180 | 40 | 140 | 8 | 158 | 2 | 8 | M16 | 18 | 4,50 |
| 125 | 5" | 10/16 | 250 | 22 | 210 | 44 | 168 | 8 | 188 | 2 | 8 | M16 | 18 | 6,50 |
| 150 | 6" | 10/16 | 285 | 22 | 240 | 44 | 194 | 10 | 212 | 2 | 8 | M20 | 22 | 7,50 |

All items and specifications are subject to revision.

Alle Maße in mm
All sizes in mm