

ECO-leichte Ausführung

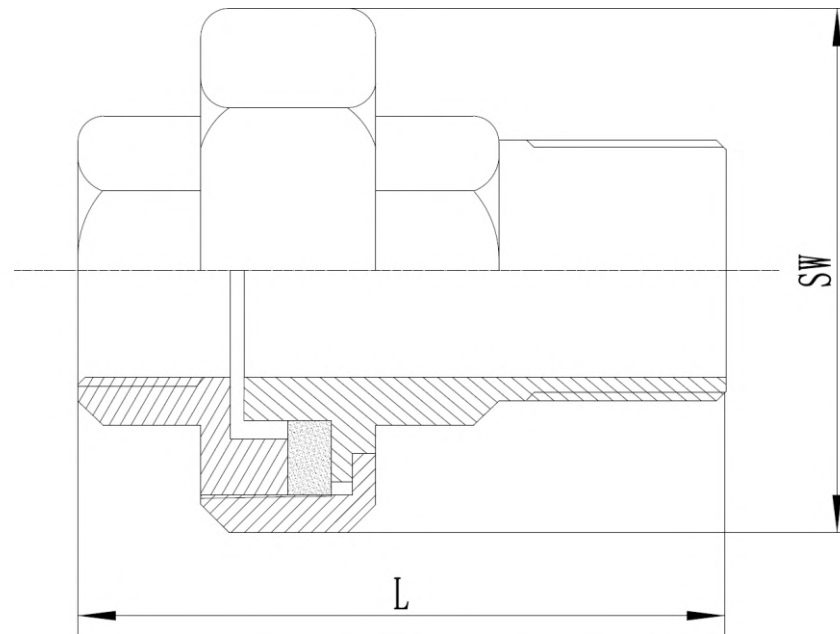

311A Verschraubung flach dichtend, Innen-/Außengewinde  
Union, flat seat, female / male thread, V4A / AISI 316

Dimension	L	SW
1/8"	30,5	25,0
1/4"	40,0	26,5
3/8"	41,0	31,0
1/2"	46,5	37,5
3/4"	52,5	46,0
1"	60,0	51,0
1 1/4"	65,0	63,0
1 1/2"	74,1	71,0
2"	76,2	83,5
2 1/2"	90,8	104,8
3"	104,5	116,8
4"	115,9	142,0

Toleranz +/- 1,0 mm