

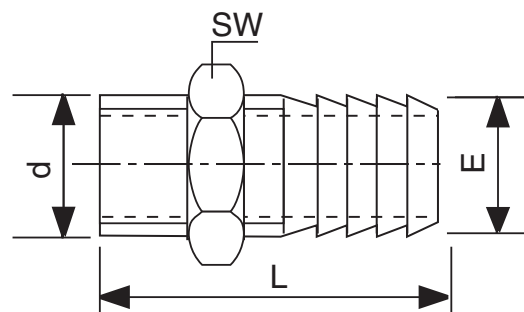

Gewinde R-EN 10226 (alt DIN 2999)

NW	d	E	L	SW	kg
6	1/8"	7 mm	41,0 mm	12 mm	0,01
8	1/4"	9 mm	47,0 mm	15 mm	0,02
10	3/8"	11 mm	56,5 mm	19 mm	0,04
15	1/2"	14 mm	66,0 mm	23 mm	0,06
20	3/4"	20 mm	70,0 mm	29 mm	0,12
25	1"	26 mm	75,0 mm	38 mm	0,15
32	1 1/4"	33 mm	81,5 mm	46 mm	0,22
40	1 1/2"	39 mm	93,5 mm	53 mm	0,30
50	2"	51 mm	100,0 mm	64 mm	0,43
65	2 1/2"	66 mm	112,0 mm	80 mm	1,40
80	3"	77 mm	123,0 mm	92 mm	1,00



Weitere Schlauchanschlüsse auf Anfrage