

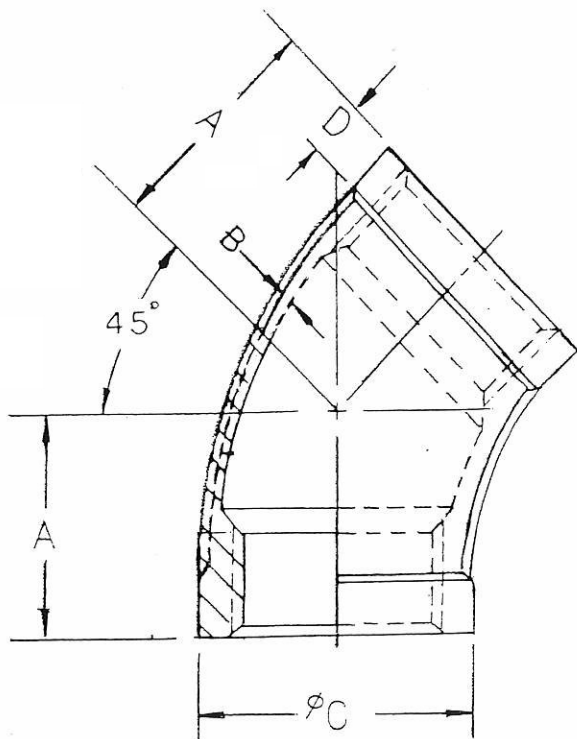

303 Winkel, 45°, I/I-Gewinde  
 Elbow, 45°, female thread, V4A / AISI 316

RO-FI / 303 (0303) 2018-08 / P

			<b>ELBOW 45'</b>		
			2018.7.30		



	A	B	$\phi C$	D						
1/8	18	1.5	15	5						
1/4	19	1.5	18.6	5						
3/8	20	1.5	22	6						
1/2	20	1.5	27	6						
3/4	23	1.6	32.5	7						
1	26	1.8	40.2	8						
1-1/4	30	2	49.7	9						
1-1/2	33	2.1	55.7	9						
2	38	2.1	68.5	10						
2-1/2	45	2.5	84.5	11						
3	52	3	100.5	12						
4	64	3.3	127	13						