

Cutting Ring Unions

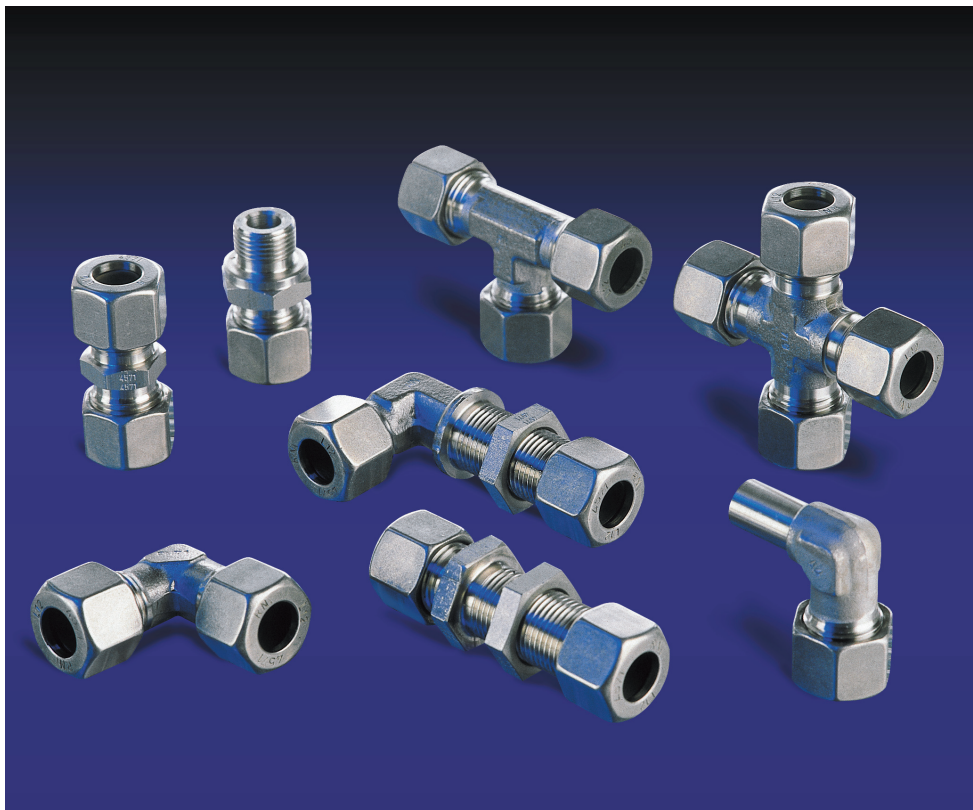

RO-FI Precision in Stainless Steel

Straight Male Stud Coupling

Metric parallel

Available acc. DIN 3852 - Form B (standard) - Form A (add "/A" to part-no.).

Form E (add "/ed" to part-no.). Sizes are approximate dimensions at tightened cap nut.

Supplementary sizes and executions on request.

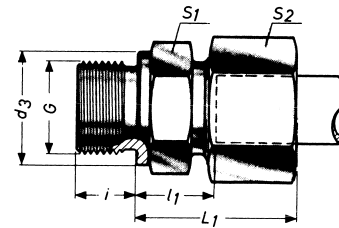

line	tube AD	L1	l1	i	S2	S1	d3	Male Stud Coupling G	ca. kg for %St. 1.4571	Order number	PLS
L slightly PN 250	6	23	8,5	8	14	14	14	M 10 x 1,0	2,5	CL 6	030
	8	25	10,0	12	17	17	17	M 12 x 1,5	3,9	CL 8	
	10	26	11,0	12	19	19	19	M 14 x 1,5	5,1	CL 10	
	12	27	12,5	12	22	22	21	M 16 x 1,5	6,8	CL 12	
	15	29	13,5	12	27	24	23	M 18 x 1,5	9,7	CL 15	
PN 160	18	31	14,5	14	32	27	27	M 22 x 1,5	14,3	CL 18	030
	22	33	16,5	16	36	32	31	M 26 x 1,5	19,5	CL 22	
PN 100	28	34	17,5	18	41	41	39	M 33 x 2,0	27,2	CL 28	030
	35	39	17,5	20	50	50	49	M 42 x 2,0	44,8	CL 35	
	42	42	19,0	22	60	55	55	M 48 x 2,0	60,9	CL 42	
S heavy PN 630	6	28	13,0	12	17	17	17	M 12 x 1,5	4,8	CS 6	031
	8	30	15,0	12	19	19	19	M 14 x 1,5	6,5	CS 8	
	10	31	15,0	12	22	22	21	M 16 x 1,5	8,6	CS 10	
	12	33	17,0	12	24	24	23	M 18 x 1,5	11,0	CS 12	
	14	37	19,0	14	27	27	25	M 20 x 1,5	14,8	CS 14	
PN 400	16	37	18,5	14	30	27	27	M 22 x 1,5	16,8	CS 16	031
	20	42	20,5	16	36	32	32	M 27 x 2,0	26,6	CS 20	
	25	47	23,0	18	46	41	39	M 33 x 2,0	48,9	CS 25	
PN 250	30	50	23,5	20	50	50	49	M 42 x 2,0	67,4	CS 30	031
	38	57	26,0	22	60	55	55	M 48 x 2,0	93,3	CS 38	

11.2007_1.000



www.rofi.de

South

Karl-Arnold-Straße 7
D-73230 Kirchheim/Teck
Tel. +49 (0) 70 21 94 35-0
Fax +49 (0) 70 21 5 60 31
kirchheim@rofi.de

North Export

Mittelgönrather Straße 15
D-42655 Solingen
Tel. +49 (0) 2 12 2 32 54-0
Fax +49 (0) 2 12 2 32 54-11
solingen@rofi.de

Middle

Ostendstraße 3
D-63110 Rodgau-Niederroden
Tel. +49 (0) 61 06 2 85 79-30
Fax +49 (0) 61 06 2 22 08
rodgau@rofi.de

RO-FI Precision in Stainless Steel



Reliability by quality management - ISO 9001