

Cutting Ring Unions

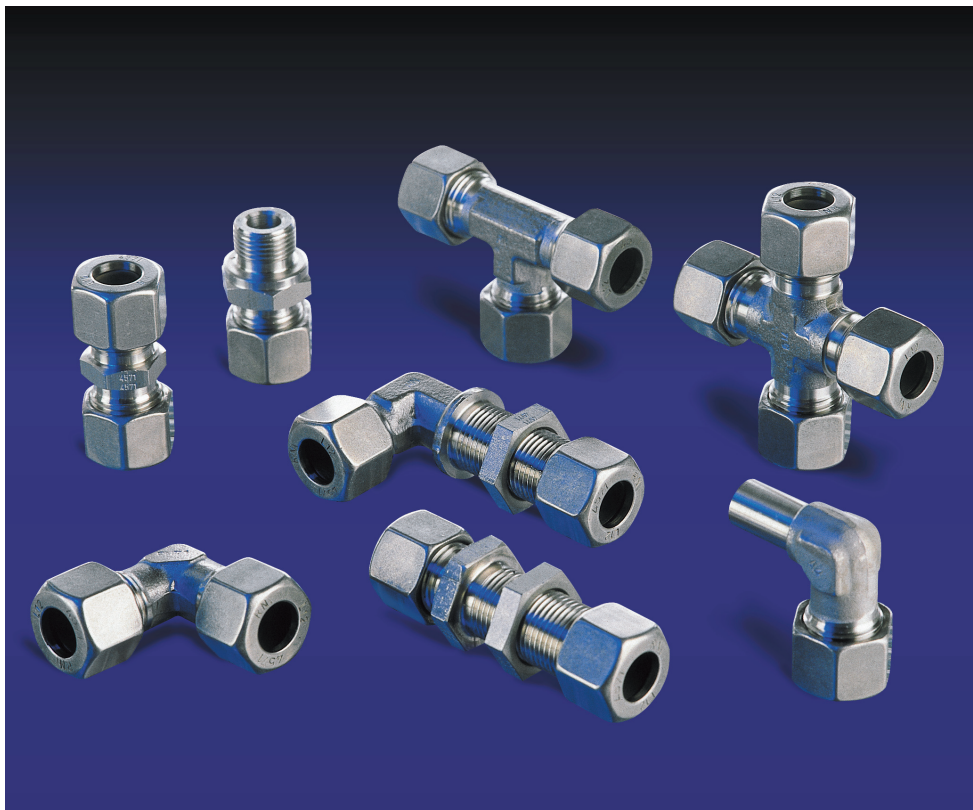

RO-FI Precision in Stainless Steel

Straight Coupling

Construction dimensions are circa dimensions at tightened connection nut

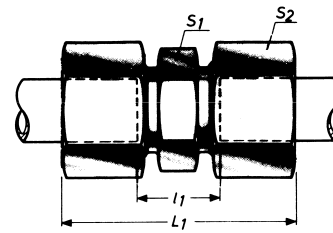

line	tube AD	S1	S2	l1	l1	ca. kg for %St. 1.4571	OrderNr.	PLS
LL very easy PN 100	4	9	10	31	12	1,5	ELL 4	006
	6	11	12	32	9	2,0	ELL 6	
	8	12	14	35	12	2,6	ELL 8	
L slightly PN 250	6	12	14	39	10	3,5	EL 6	007
	8	14	17	40	11	5,0	EL 8	
	10	17	19	42	13	6,5	EL 10	
	12	19	22	43	14	8,4	EL 12	
PN 160	18	27	32	48	16	20,1	EL 18	007
	22	32	36	52	20	27,4	EL 22	
	28	41	41	54	21	34,1	EL 28	
PN 100	35	46	50	63	20	54,3	EL 35	007
	42	55	60	66	21	81,9	EL 42	

line	tube AD	S1	S2	l1	l1	ca. kg for %St. 1.4571	OrderNr.	PLS
S heavy PN 630	6	14	17	45	16	6,1	ES 6	008
	8	17	19	47	18	7,9	ES 8	
	10	19	22	49	17	10,8	ES 10	
	12	22	24	51	19	13,3	ES 12	
PN 400	14	24	27	57	22	18,4	ES 14	008
	16	27	30	57	21	22,7	ES 16	
	20	32	36	66	23	36,9	ES 20	
PN 250	25	41	46	74	26	69,7	ES 25	008
	30	46	50	80	27	82,5	ES 30	
	38	55	60	90	29	126,3	ES 38	

11.2007_1.000



www.rofi.de

South

Karl-Arnold-Straße 7
D-73230 Kirchheim/Teck
Tel. +49 (0) 70 21 94 35-0
Fax +49 (0) 70 21 5 60 31
kirchheim@rofi.de

North Export

Mittelgönrather Straße 15
D-42655 Solingen
Tel. +49 (0) 2 12 2 32 54-0
Fax +49 (0) 2 12 2 32 54-11
solingen@rofi.de

Middle

Ostendstraße 3
D-63110 Rodgau-Niederroden
Tel. +49 (0) 61 06 2 85 79-30
Fax +49 (0) 61 06 2 22 08
rodgau@rofi.de

RO-FI Precision in Stainless Steel



Reliability by quality management - ISO 9001