

Cutting Ring Unions

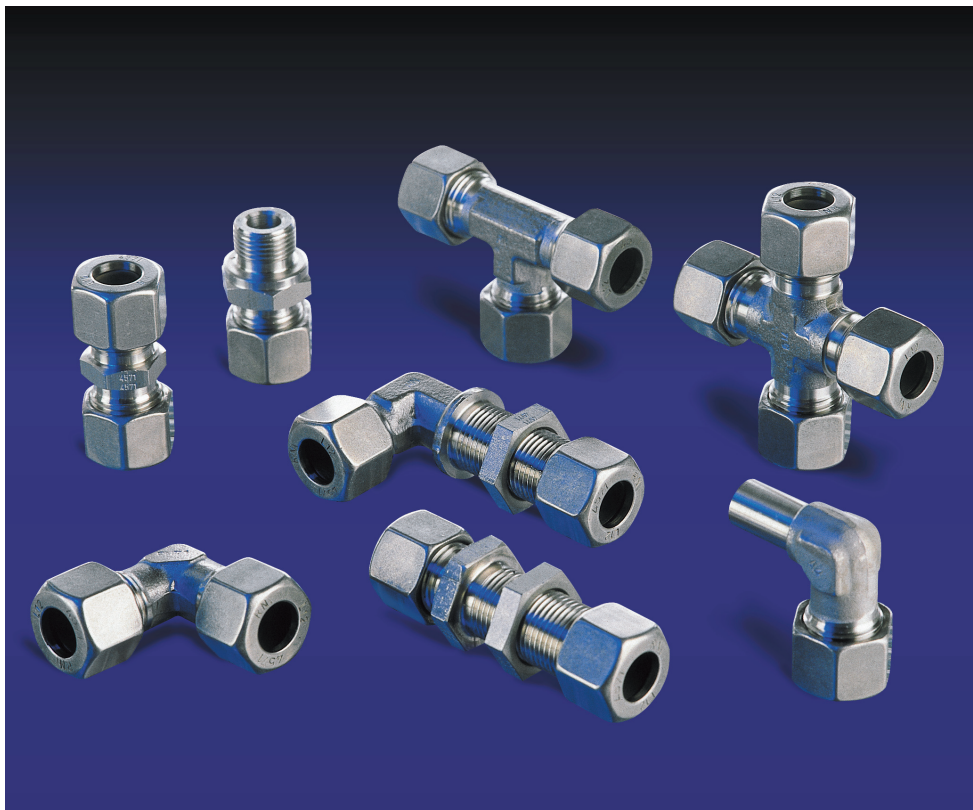

RO-FI Precision in Stainless Steel

Equal Tee Coupling

Sizes are approximate dimensions at tightened cap nut.
Reduced tee-couplings available in all different sizes.

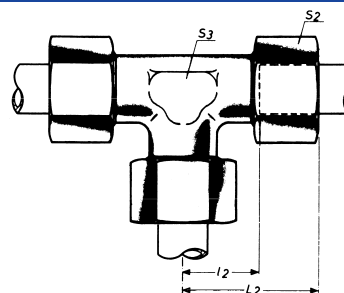

line	tube		S ₃	L ₂	l ₂	ca. kg for %St.			PLS
	AD	S ₂				1.4571	OrderNr.	1.4571	
LL very easy PN 100	4	10	9	21	11,0	2,8	QLL 4	012	
	6	12	9	21	9,5	3,3	QLL 6		
	8	14	12	23	11,5	4,5	QLL 8		
L slightly PN 250	6	14	12	27	12,0	6,2	QL 6	013	
	8	17	12	29	14,0	10,3	QL 8		
	10	19	14	30	15,0	10,7	QL 10		
	12	22	17	32	17,0	13,7	QL 12		
	15	27	19	36	21,0	23,4	QL 15		
PN 160	18	32	24	40	23,5	35,1	QL 18	013	
	22	36	27	44	27,5	46,8	QL 22		
PN 100	28	41	36	47	30,5	62,6	QL 28	013	
	35	50	41	56	34,5	97,5	QL 35		
	42	60	50	63	40,0	147,7	QL 42		

line	tube		S ₃	L ₂	l ₂	ca. kg for %St.			PLS
	AD	S ₂				1.4571	OrderNr.	1.4571	
S heavy PN 630	6	17	12	31	16,0	10,3	QS 6	014	
	8	19	14	32	17,0	12,8	QS 8		
	10	22	17	34	17,5	17,3	QS 10		
	12	24	17	38	21,5	21,9	QS 12		
PN 400	14	27	19	40	22,0	29,2	QS 14	014	
	16	30	24	43	24,5	37,0	QS 16		
	20	36	27	48	26,5	60,2	QS 20		
PN 250	25	46	36	54	30,0	112,8	QS 25	014	
	30	50	41	62	35,5	139,2	QS 30		
PN 250	38	60	50	72	41,0	210,7	QS 38	014	

11.2007_1.000

www.rofi.de



www.rofi.de

South

Karl-Arnold-Straße 7
D-73230 Kirchheim/Teck
Tel. +49 (0) 70 21 94 35-0
Fax +49 (0) 70 21 5 60 31
kirchheim@rofi.de

North Export

Mittelgönrather Straße 15
D-42655 Solingen
Tel. +49 (0) 2 12 2 32 54-0
Fax +49 (0) 2 12 2 32 54-11
solingen@rofi.de

Middle

Ostendstraße 3
D-63110 Rodgau-Niederroden
Tel. +49 (0) 61 06 2 85 79-30
Fax +49 (0) 61 06 2 22 08
rodgau@rofi.de

RO-FI Precision in Stainless Steel



Reliability by quality management - ISO 9001