

Cutting Ring Unions

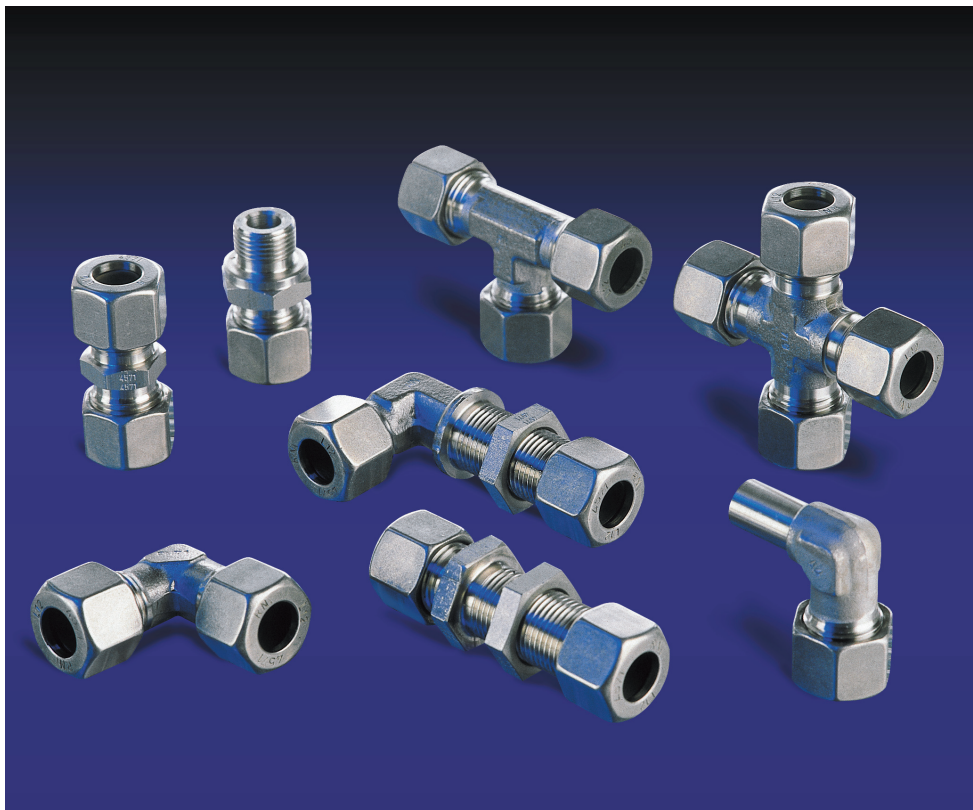

RO-FI Precision in Stainless Steel

Equal Elbow Coupling

Sizes are approximate dimensions at tightened cap nut.

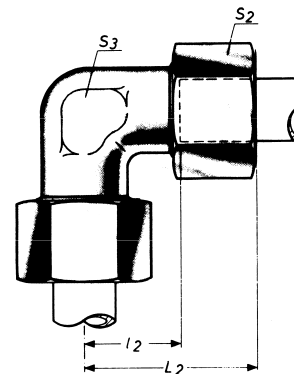

line	tube AD	S ₂	S ₃	L ₂	l ₂	ca. kg for %St. 1.4571		OrderNr.	PLS
LL very easy PN 100	4	10	9	21	11,0	1,9		KLL 4	009
	6	12	9	21	9,5	2,2		KLL 6	
	8	14	12	23	11,5	3,1		KLL 8	
L slightly PN 250	6	14	12	27	12,0	4,2		KL 6	010
	8	17	12	29	14,0	5,9		KL 8	
	10	19	14	30	15,0	7,4		KL 10	
	12	22	17	32	17,0	9,9		KL 12	
PN 160	18	32	24	40	23,5	24,8		KL 18	010
	22	36	27	44	27,5	33,1		KL 22	
PN 100	28	41	36	47	30,5	44,8		KL 28	010
	35	50	41	56	34,5	73,2		KL 35	
	42	60	50	63	40,0	111,6		KL 42	

line	tube AD	S ₂	S ₃	L ₂	l ₂	ca. kg for %St. 1.4571		OrderNr.	PLS
S heavy PN 630	6	17	12	31	16,0	7,0		KS 6	011
	8	19	14	32	17,0	9,0		KS 8	
	10	22	17	34	17,5	12,4		KS 10	
	12	24	17	38	21,5	15,5		KS 12	
	14	27	19	40	22,0	20,3		KS 14	
PN 400	16	30	24	43	24,5	26,2		KS 16	011
	20	36	27	48	26,5	42,1		KS 20	
	25	46	36	54	30,0	80,4		KS 25	
PN 250	30	50	41	62	35,5	102,3		KS 30	011
	38	60	50	72	41,0	156,5		KS 38	

11.2007_1.000



www.rofi.de

South

Karl-Arnold-Straße 7
D-73230 Kirchheim/Teck
Tel. +49 (0) 70 21 94 35-0
Fax +49 (0) 70 21 5 60 31
kirchheim@rofi.de

North Export

Mittelgönrather Straße 15
D-42655 Solingen
Tel. +49 (0) 2 12 2 32 54-0
Fax +49 (0) 2 12 2 32 54-11
solingen@rofi.de

Middle

Ostendstraße 3
D-63110 Rodgau-Niederroden
Tel. +49 (0) 61 06 2 85 79-30
Fax +49 (0) 61 06 2 22 08
rodgau@rofi.de

RO-FI Precision in Stainless Steel



Reliability by quality management - ISO 9001