

## Screwed fittings



RO-FI Precision in Stainless Steel



11.2007\_1.000

www.rofi.de

d2-d1	L	kg	d2-d1	L	kg
1/4" - 1/8"	27 mm	0,03	1 1/4" - 1"	44 mm	0,17
3/8" - 1/8"	34 mm	0,04	1 1/2" - 1/2"	48 mm	0,20
3/8" - 1/4"	34 mm	0,04	1 1/2" - 3/4"	48 mm	0,17
1/2" - 1/8"	36 mm	0,07	1 1/2" - 1"	48 mm	0,34
1/2" - 1/4"	36 mm	0,07	1 1/2" - 1"	48 mm	0,34
1/2" - 3/8"	36 mm	0,07	2" - 3/4"	56 mm	0,31
3/4" - 1/4"	35 mm	0,09	2" - 1"	56 mm	0,31
3/4" - 3/8"	35 mm	0,10	2" - 1 1/4"	56 mm	0,35
3/4" - 1/2"	35 mm	0,07	2" - 1 1/2"	56 mm	0,36
1" - 3/8"	40 mm	0,16	2 1/2" - 1 1/2"	62 mm	0,76
1" - 1/2"	40 mm	0,10	2 1/2" - 2"	62 mm	0,52
1" - 3/4"	40 mm	0,11	3" - 2"	67 mm	0,73
1 1/4" - 1/2"	44 mm	0,20	3" - 2 1/2"	76 mm	0,85

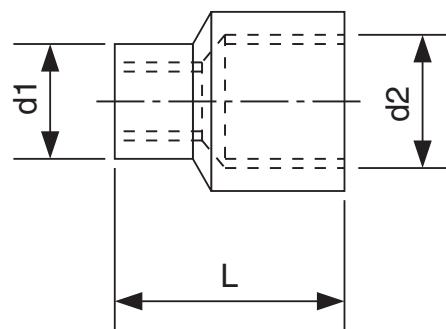



www.rofi.de

#### South

Karl-Arnold-Straße 7  
D-73230 Kirchheim/Teck  
Tel. +49 (0) 70 21 94 35-0  
Fax +49 (0) 70 21 5 60 31  
kirchheim@rofi.de

#### North Export

Mittelgönrather Straße 15  
D-42655 Solingen  
Tel. +49 (0) 2 12 2 32 54-0  
Fax +49 (0) 2 12 2 32 54-11  
solingen@rofi.de

#### Middle

Ostendstraße 3  
D-63110 Rodgau-Niederroden  
Tel. +49 (0) 61 06 2 85 79-30  
Fax +49 (0) 61 06 2 22 08  
rodgau@rofi.de

RO-FI Precision in Stainless Steel



Reliability by quality management - ISO 9001